

## Specifications

| Model                                    | CLA□-02□-□                                      | CLK□-02□-C□                                     | CWA□S-24-CD                                     |
|--|---|---|---|
| Rated Voltage                            | 24V DC (Polarized)                              |   |   |
| Operating Ambient Temperature / Humidity | -40°C - +60°C / Less than 90% (No condensation) |   | -30°C - +60°C / Less than 90% (No condensation) |
| Mounting Location                        | Indoors (All Directions)                        |   |   |
| Protection Rating                        | IP66, IP67 / IP69K (Excluding Cable Terminal)   | IP66G, IP67G / IP69K (Excluding Cable Terminal) | IP65 (Excluding Cable Terminal)                 |

## Dimensions (Unit:mm)

### ■ CLA□-02□-□

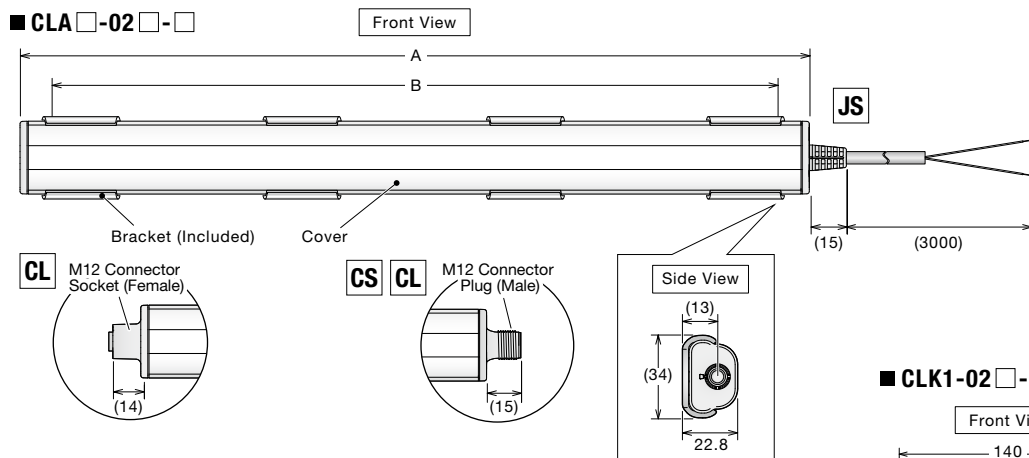

|      | Product length<br>A | Illuminated Area<br>B | Number of Brackets Included |
|------|---------------------|-----------------------|-----------------------------|
|      | A                   | B                     |                             |
| CLA1 | 125                 | 100                   | 2                           |
| CLA2 | 225                 | 200                   | 2                           |
| CLA3 | 325                 | 300                   | 2                           |
| CLA6 | 625                 | 600                   | 2                           |
| CLA9 | 925                 | 900                   | 4                           |

### ■ CLK3-02□-C / CLK6-02□-C

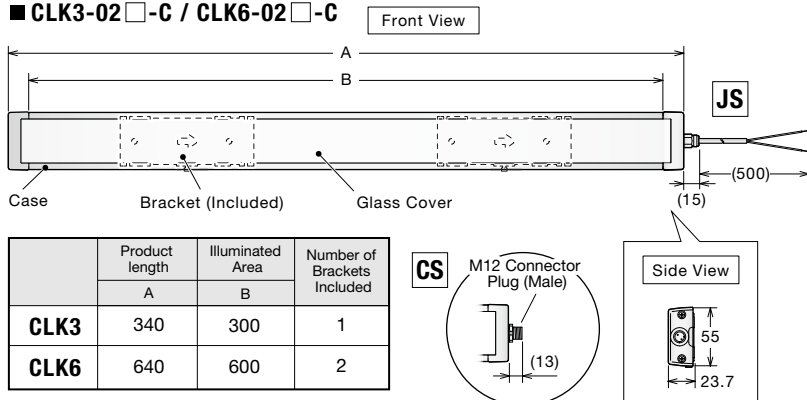

|      | Product length<br>A | Illuminated Area<br>B | Number of Brackets Included |
|------|---------------------|-----------------------|-----------------------------|
|      | A                   | B                     |                             |
| CLK3 | 340                 | 300                   | 1                           |
| CLK6 | 640                 | 600                   | 2                           |

### ■ CLK1-02□-CP

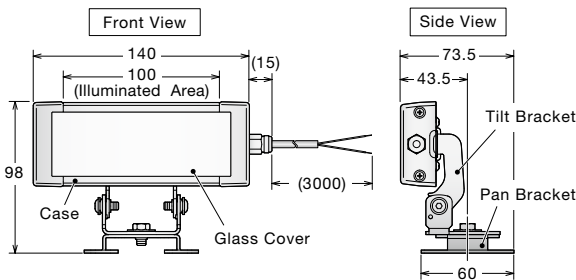

### ■ CLK1-02□-C

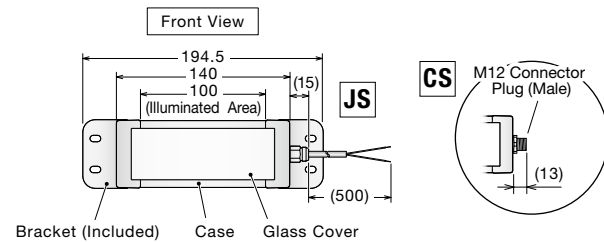

|      | Dimension |     | Number of Brackets Included |
|------|-----------|-----|-----------------------------|
|      | A         | B   |                             |
| CWA3 | 315.5     | 300 | 2                           |
| CWA6 | 621.0     | 600 | 2                           |
| CWA9 | 916.5     | 900 | 2                           |

### ■ CWA□S-24-CD

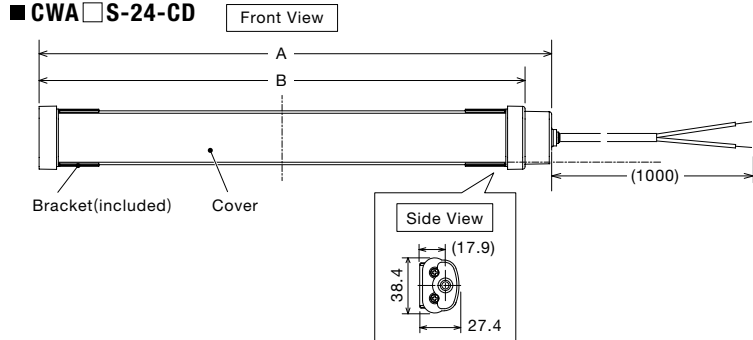

## PATLITE Corporation

PATLITE (U.S.A.) Corporation

PATLITE Europe GmbH

PATLITE UK LTD

PATLITE (CHINA) Corporation

PATLITE KOREA CO., LTD.

PATLITE TAIWAN CO., LTD.

PATLITE (THAILAND) CO., LTD.

PATLITE (SINGAPORE) PTE LTD

PT. PATLITE INDONESIA

### ⚠ CAUTION

To ensure correct use of these products, read the "Instruction Manual" prior to use. Failure to follow all safeguards can result in fire, electric shock, or other accidents. Specifications are subject to change without notice.

0-BE08A EN 2511

# PATLITE®

LED Work Light  
CLA/CWA/CLK

# Durable Industrial LED Lighting

## Efficient and IP Rated for Harsh Environments



LED Work Light  
**CLA**  
Series

ECOLAB®

Indoor

ALL  
Directions

+60℃  
-40℃

Daylight  
6,500K

Amber  
590nm

LED  
75,000h

CE /  
RoHS10

UL

IP66

IP67

IP69K

Hygiene-Critical LED Lighting Solutions  
Durability Certified for Food, Beverage & Pharma

- Impact-resistant polycarbonate housing with milky-white body for bright, uniform illumination
- IP67/69K compliant; suitable for high-pressure, high-temperature washdown processes
- ECOLAB-tested for resistance to cleaning agents, supporting strict hygiene management
- Amber model optimized for semiconductor tools and cleanroom applications

Model Code

**C L A 3 - 0 2 J S N - C**

Length of Illumination Area

|   |       |
|---|-------|
| 1 | 100mm |
| 2 | 200mm |
| 3 | 300mm |
| 6 | 600mm |
| 9 | 900mm |

Rated Voltage

|    |       |
|----|-------|
| 02 | DC24V |
|----|-------|

Wiring Type

|    |                           |
|----|---------------------------|
| JS | Cable                     |
| CS | M12 Connector             |
| CL | M12 Connector Daisy chain |

Luminous Color

|   |          |
|---|----------|
| C | Daylight |
| Y | Amber    |

Product List

| Model Code   | Length | Luminous Color    | Total Luminous Flux | Illuminance (at 1 m) | Wiring Type               | Rated Voltage | Power Consumption (typ.) |
|--------------|--------|-------------------|---------------------|----------------------|---------------------------|---------------|--------------------------|
| CLA1-02JSN-C | 100mm  | Daylight (6,500K) | 235lm               | 72lx                 | Cable                     | 24V DC        | 1.9W                     |
| CLA1-02CSN-C |        |                   |                     |                      | M12 Connector (4pin)      |               |                          |
| CLA2-02JSN-C | 200mm  |                   | 480lm               | 145lx                | Cable                     |               | 3.8W                     |
| CLA2-02CSN-C |        |                   |                     |                      | M12 Connector (4pin)      |               |                          |
| CLA3-02JSN-C | 300mm  | Daylight (6,500K) | 595lm               | 180lx                | Cable                     |               | 4.5W                     |
| CLA3-02CSN-C |        |                   |                     |                      | M12 Connector (4pin)      |               |                          |
| CLA3-02CLN-C |        |                   |                     |                      | M12 Connector Daisy chain |               |                          |
| CLA3-02JSN-Y |        | Amber             | 140lm               | 43lx                 | Cable                     |               | 3.8W                     |
| CLA6-02JSN-C | 600mm  | Daylight (6,500K) | 1,190lm             | 350lx                | Cable                     |               | 9.0W                     |
| CLA6-02CSN-C |        |                   |                     |                      | M12 Connector (4pin)      |               |                          |
| CLA6-02JSN-Y |        | Amber             | 280lm               | 82lx                 | Cable                     |               | 7.6W                     |
| CLA9-02JSN-C | 900mm  | Daylight (6,500K) | 1,785lm             | 480lx                | Cable                     |               | 13.5W                    |
| CLA9-02CSN-C |        |                   |                     |                      | M12 Connector (4pin)      |               |                          |

Outstanding Brightness with Improved Energy Efficiency

Robust light distribution and superior luminous efficacy

Compared to previous models, total luminous flux has increased by 65% and illuminance by 71%.\* The seamless, milky-white housing delivers uniform brightness across a wide 120° beam angle. Luminous efficacy has been significantly enhanced, providing exceptional brightness while reducing energy consumption.

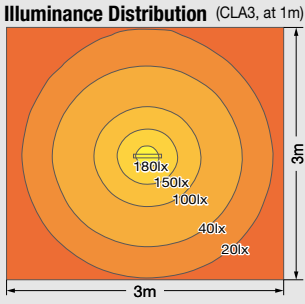
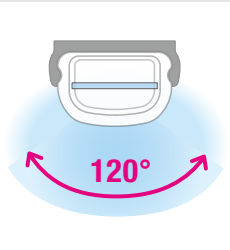

\* Illuminance values are calculated and may differ from actual measurements.

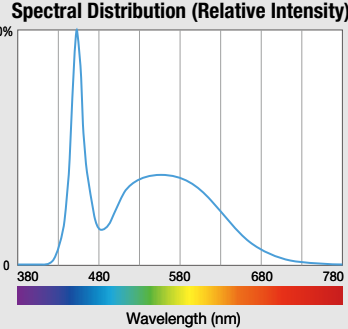

Highly Durable and Hygienic Design

Built for rigorous washdowns, chemical sanitization, and sterilization

Impact-resistant polycarbonate housing prevents breakage and protects against foreign object contamination. With an operating temperature range of -40°C to +60°C and IP69K compliance, this lighting solution delivers exceptional durability. It is ideal for demanding applications such as low-temperature warehouses and equipment that require high-temperature washdowns, while supporting chemical sanitization and sterilization processes.



IP67/IP69K

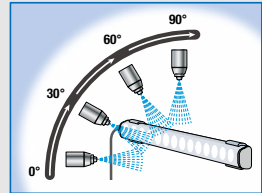

ECOLAB\*

H<sub>2</sub>O<sub>2</sub> Resistance

Compatible with cleaning agents and hydrogen peroxide sterilization

\*Tested and passed for the listed types (using SUS bracket: SZW-304)

| Characteristics                | Item           | Concentration |
|--------------------------------|----------------|---------------|
| Alkaline Cleaning              | Topaz MD6      | 5%            |
| Acidic Cleaning                | Topactive 500  | 6%            |
| Chlorinated Alkaline Cleaning  | P3-Topax 66    | 3%            |
| Acidic, Oxidative Disinfection | Topactive OKTO | 3%            |
| Neutral Cleaning               | P3-Topax 990   | 3%            |

Reduced Wiring and Simplified Installation

In addition to conventional cable connections (JS type), M12 connector (CS type) and M12 connector Daisy chain (CL type) options are available, reducing wiring errors and labor for a faster, more reliable setup.

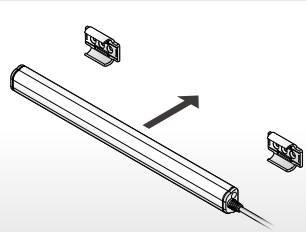

The slim housing can be easily mounted using the included rear bracket (SZW-301), with magnetic mounts and optional SUS stainless steel brackets providing additional flexibility.

Amber LED Optimized for Semiconductor Manufacturing

The CLA-Y amber model is designed for lithography and exposure processes in semiconductor fabs. With a dominant wavelength of 590nm and minimal blue light (430-490nm), it provides safe, cleanroom-compatible illumination ideal for sensitive manufacturing environments.

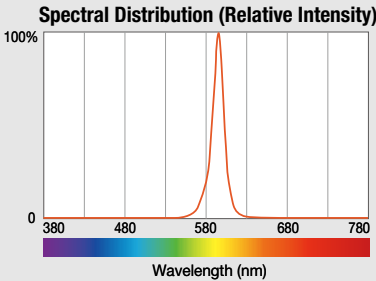

Optional Brackets



Rear Screw Mount  
\*Bracket included with light bar  
Material : PC **SZW-301**



Rear Magnet Mount  
Material : PC **SZW-302**



Rear Screw Mount  
Material : PC **SZW-303**



Rear Screw Mount  
Material : SUS **SZW-304**



LED Work Light  
CLK  
Series

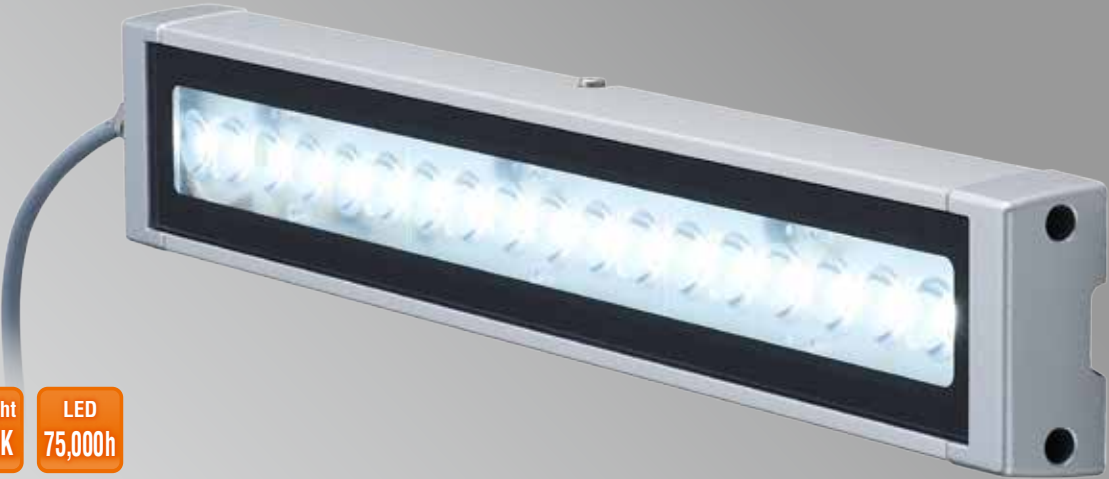

Indoor

ALL  
Directions

+60℃  
-40℃

Daylight  
6,500K

LED  
75,000h

CE /  
RoHS10

UL

IP66G

IP67G

IP69K

Watertight and Oil-Resistant Design for  
Machine Tool Interiors

- Rugged and refined LED lighting with aluminum housing and tempered glass
- Proprietary lens design ensures uniform brightness for clear illumination inside equipment
- Oil-resistant construction with IP66G/67G protection for use in harsh environments
- Spotlight model features collimating lens with adjustable pan-tilt angles

Model Code

CLK1-02JSN-CP

Length of Illumination Area

|   |       |
|---|-------|
| 1 | 100mm |
| 3 | 300mm |
| 6 | 600mm |

Rated Voltage

|    |       |
|----|-------|
| 02 | DC24V |
|----|-------|

Wiring Type

|    |               |
|----|---------------|
| JS | Cable         |
| CS | M12 Connector |

Luminous Color

|   |          |
|---|----------|
| C | Daylight |
|---|----------|

Lens

|           |          |
|-----------|----------|
| No Symbol | Standard |
| P         | Spot     |

Product List

| Model Code    | Length | Luminous Color    | Total Luminous Flux | Illuminance (at 1 m) | Wiring Type          | Rated Voltage | Power Consumption (typ.) |
|---------------|--------|-------------------|---------------------|----------------------|----------------------|---------------|--------------------------|
| CLK1-02JSN-C  | 100mm  | Daylight (6,500K) | 450lm               | 550lx                | Cable                | 24V DC        | 3.6W                     |
| CLK1-02CSN-C  |        |                   |                     |                      | M12 Connector (2pin) |               |                          |
| CLK1-02JSN-CP |        |                   |                     |                      | Cable                |               |                          |
| CLK3-02JSN-C  | 300mm  |                   | 1,300lm             | 1,600lx              | Cable                |               | 10.7W                    |
| CLK3-02CSN-C  |        |                   |                     |                      | M12 Connector (2pin) |               |                          |
| CLK6-02JSN-C  | 600mm  |                   | 2,600lm             | 2,500lx              | Cable                |               | 21.5W                    |
| CLK6-02CSN-C  |        |                   |                     |                      | M12 Connector (2pin) |               |                          |

Excellent Light Distribution Characteristics

Two lens types are available: standard and spot. Choose the standard lens model for wide-area lighting inside machines, or the spot lens model for detailed illumination of specific targets. Natural light with a color rendering index of Ra80 brightly illuminates both surroundings and workpieces.

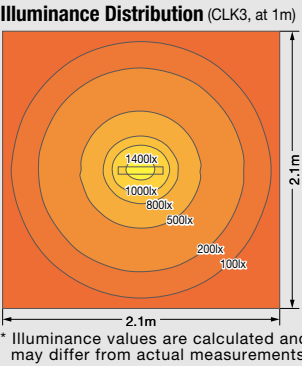

Watertight, Dust tight, and Oil-Resistant LED Lights

These LED lights prevent ingress of coolant and chips

In addition to IP66/67 ratings, auxiliary oil protection grades are provided. Protection grade “G” ensures that oil droplets and mist from any direction will not enter the interior, making them ideal for harsh industrial environments.



Oil Resistance Testing  
Proven Oil-Resistance

In addition to standard IP testing, we perform proprietary oil-resistance tests in-house. Products are immersed in water-soluble oil for 240 hours (10 days) to verify their oil resistance, supporting our ongoing commitment to high-quality, durable products.

IP66G/67G (JIS C0920)

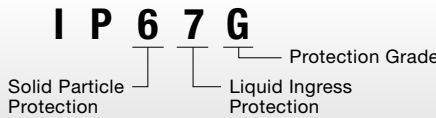

The oils used for testing were diluted 20x and immersion was performed at room temperature for 240 hours (10 days).

| Name of Company                     | Name of Oil               |
|-------------------------------------|---------------------------|
| Hangsterfer's                       | HANGSTERFER S500          |
| Yushiro Chemical Industry Co., Ltd. | Yushiroken Synthetic #663 |
| Castrol                             | Syntilo 9954              |
| Blaser Swisslube                    | Blasocut BC35LFSW         |
|                                     | Grindex 10 CO             |

Spotlight for Machine Tools

A spotlight model is available with a spot lens and a pan-tilt bracket (included with the main unit). It provides bright illumination even for the fine details of the target, ensuring precise visibility during machine operations.



CLK1-02JSN-CP

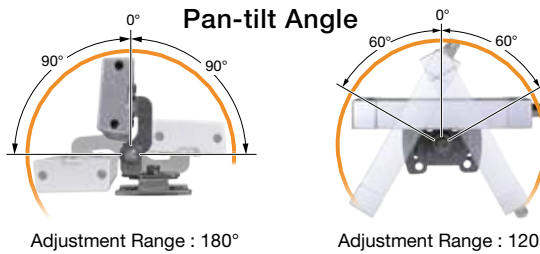

Mounting Examples (ex: CLK3)

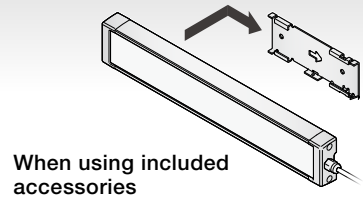

When using included accessories

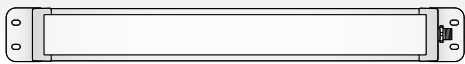

When using SZW-305 (optional)

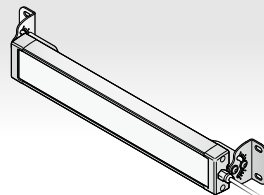

When using SZW-306 (optional)

Optional Brackets

Rear Mount  
Material : SUS  
SZW-305



Angle Adjustment  
Material : SUS  
SZW-306



Pan-tilt  
(Compatible model: CLK1)  
Material : SUS  
SZW-307



LED Work Light  
**CWA**  
Series



Highly-reliable LED chips are used

Indoor

ALL  
Directions

+60 °C  
-30 °C

Daylight  
6,500K

LED  
40,000h

CE /  
RoHS10

UL

IP65

Equipped with Essential Features, This LED Light  
Delivers Versatile Performance for Many Applications

Model Code

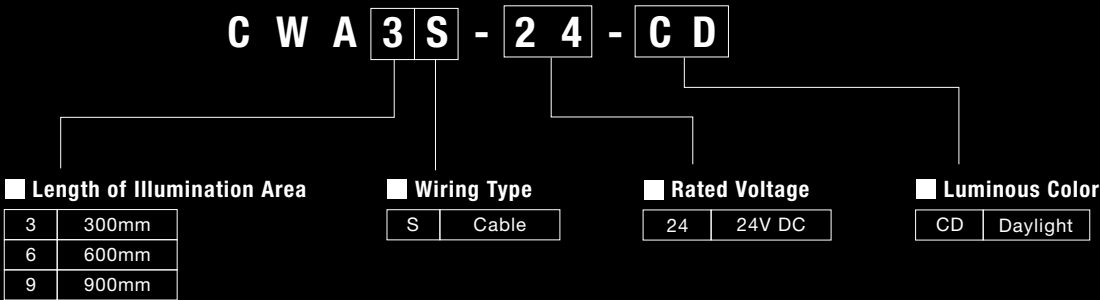

Product List

| Model Code  | Length | Luminous Color    | Total Luminous Flux | Illuminance (at 1 m) | Wiring Type | Rated Voltage | Power Consumption (typ.) |
|-------------|--------|-------------------|---------------------|----------------------|-------------|---------------|--------------------------|
| CWA3S-24-CD | 300mm  | Daylight (6,500K) | 385lm               | 110lx                | Cable       | 24V DC        | 4.32W                    |
| CWA6S-24-CD | 600mm  |                   | 770lm               | 220lx                | Cable       |               | 8.64W                    |
| CWA9S-24-CD | 900mm  |                   | 1,155lm             | 330lx                | Cable       |               | 12.96W                   |

LED Work Light **CLA / CLK / CWA** | Application Examples

Control Panel

Uniform, even illumination enhances work efficiency.



Machining Center

Clear visibility for easier monitoring of machining.



Food Processing Line

Durable LED lighting for strict hygiene management.



\*Alkaline detergents: ensure compatibility before application.

Electrical Discharge Machine

Designed for harsh environments with splashing coolant and flying debris.



Semiconductor Manufacturing Plant

Minimizes photoresist exposure in lithography processes.



Cutting Machine

Illuminates fine details to enhance productivity.



Brackets

Mounting Brackets

Material : SUS



Holding Brackets

Material : SUS

